

3S – Betterpack Packer – Water Activated Tape

Product code: 21BP3STAPER



Features and Benefits:

- Ease of use and maintenance
- Pull and Tear
- Steel Frame – Powder Coated – Heavy duty
- Entry Level Option – Low Volume
- Offers Uniform tape moistening and easy operation
- Works with both reinforced and non-reinforced water-activated tape.



Specifications:

Model:	Packer3S
Power Supply:	Not Applicable
Max Power:	Not Applicable
Overall Dimensions:	368mm x 152mm x 152mm
Shipping Weight:	2.7 Kg's
Tape roll Capacity:	Up to 200 meter on a roll
	48mm/60mm/70mm
Dispensing Speed:	Manual – Pull and Tear
Water Bottle Capacity:	Water Tank – 150ml
Blades	Cutting Knife

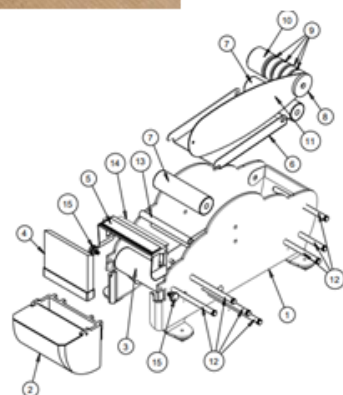

Works with WAT – Water Activated Tape – Reinforced and Plain (Print up to 8 Colour)
Manufactured by Bidvest Afcom



Directions for use:

To Fill Tank

1. Remove lid and brush from tank.
2. Fill tank to ½" from top.
3. Thoroughly wash brush in warm soapy water before initial use.
4. Replace brush into tank.

To Load Tape

1. Unroll 15 inches of tape (see figure 1).
2. Place tape in tape cradle and be sure tape divider is in proper position to fit width of tape.
3. Insert tape-end in back of two rollers. Push the tape through the underside of the dispenser until the end comes out in front of the tape cradle (see figure 2).
4. Thread the tape-end between the knife and bridge plate and out over the brush (see figure 3 & 4).



To Operate

1. Press tape against back of bridge plate and feed a short piece (see figure 6).
2. Pull tape out in a slightly downward direction to insure thorough moistening (see figure 7).
3. Draw out tape and tear off desired length



Suggestions for Maintenance

1. Keep the tank two thirds full for best moistening. Check water level to insure satisfactory moistening of tape.
2. Clean brush with soap and rinse once a week to eliminate adhesive build-up.
3. Remove cutting knife and bridge plate monthly for cleaning.
4. Periodically lubricate rolling bearing with a drop of light oil to insure smooth and efficient operation.
5. The tank is easily removed for cleaning. Unsnap the bridge plate and cutter knife at sides and remove; then lift off tank. To re-assemble hook tank into position and snap on bridge plate with the serrated cutting lip towards the front of the machine